

Tilting Drum Mixer D 100c - D 120c - D 150c



Please read this user information and the safety advises before starting and observe them carefully! Keep this manual ready to hand.



Diem Werke GmbH & Co.
Lindauer Straße 60, A-6911 Lochau Austria
Phone: +43 / 5574 / 42874, Telefax: +43 / 5574 / 46418
office@diemwerke.com, <http://www.diem.at/diem>

0.0. Structure of the information

This manual is intended to enable a quick and easy manipulation of the **Tilting Drum Mixer D100c, D120c, D150c (later called mixer)** and to serve thereafter as a reference manual. This user information is written for trained staff and is intended to supply assistance during the start-up and daily operation as well as the maintenance and repair work. The respective chapter can be quickly found by means of the list of contents at the beginning.

Please read the user information and get familiar with the **DIEM Tilting Drum Mixer**. Pay attention to the safety advises. These will help you to avoid accidents and damages. The symbols will draw your attention to most relevant points. The meaning of the symbols is explained below.



Attention, caution, warning, danger



Advice, important



Execution, actuation



Maintenance, service

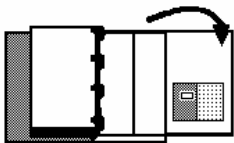

A clearly structured concept will show you how the machine functions and how it can be quickly made ready to operate. The marginal column contains a short reference concerning the contents of the chapter in question.

Open the folder at the end of the user information to have an illustration of the **mixer** available at any time.

Your suggestions and critical comments concerning this manual will be appreciated and will help us to improve the quality of our user information. Please fill up and return the reply card (annexed at the end of this manual). Should you have any more question concerning the operation of your mixer, please get into direct contact with the manufacturer.

0.0. Structure of the information



Attention! Please read the chapter „Safety“ before starting to work with the Diem **mixer!**

This user information applies exclusively to the Diem mixer

Type: D 100c D 120c D 150c 230V 400V

Serial number:

Year of construction:



CE Certificate of conformity: This **mixer** conforms with the Machine Regulations (98/37/EG) and the safety and sanitary requirements. It is qualified to bear the CE distinguishing mark.



Copyright In the absence of a consent in writing by the editor, no part of this user information is allowed to be copied, stored, used in a seeking system or otherwise transmitted.

Copyright c 1997, Diem-Werke Ges.m.b.H. & Co. All rights reserved.



Trade mark, logo:

This is the company logo of Diem-Werke Ges.m.b.H. & Co



Made in Austria: Edition 07/2000. Printed in Austria.

0.0 List of contents

1.0. Safety	Page 05
1.1. Use according to destination	Page 05
1.2. Safety advises (device-specific)	Page 06
2.0. Machine data	Page 09
2.1. Machine data (control)	Page 10
2.2. Ordering of spare parts	Page 11
2.3. Guarantee clauses	Page 11
3.0. Device Description	Page 12
3.1. Mounting / Start-up	Page 12
4.0. Transport	Page 13
4.1. Dimensions	Page 13
4.2. Transport	Page 13
4.3. Storage	Page 13
5.0. Mounting / Starting	Page 14
5.1. Site / Feeding	Page 14
5.2. Set up	Page 15
5.3. Feeding	Page 15
5.4. Connection	Page 16
5.5. Safety equipment	Page 16
5.6. Test run	Page 16
5.7. Dismantling the mixer	Page 17
6.0. Setting up and Turning on	Page 18
7.0. Operation.	Page 20
8.0. Components and conversion.	Page 24
9.0. Problem resolution	Page 25
10.0. Maintenance	Page 26
11.0. Annex	Page 31

1.0. Safety

The DIEM **mixer** has been designed and realised in accordance with the latest state of the art and is reliable in its operation. Nevertheless there may be involved dangers in the event of

- inexpert handling by insufficiently qualified and trained staff;
- failure to comply with the instructions and safety advises,
- use contrary to the intended purpose.



Attention! Please read the user information before carrying out any mounting work or initial operation! The mixer is only allowed to be operated by people who will observe the user information and safety advises and who are fully familiar with the machine.



When opening the machine (switch cupboard, terminal boards at the motors etc.), dangerous voltage points may become accessible. Any contact with the live parts may cause serious injuries or death.



1.1. Use in according to destination

Please read the user information before starting the machine and observe it carefully!

The Tilting Drum Mixers **D 100c**, **D 120c** and **D 150c** may only be used for the mixing of the following media:

- End product (cement, mortar)
- Chemicals, powders, grains
- Oil muds

Any other use is not approved. Explosive or aggressive mixes should never be used.



When operating the Tilting drum mixer, your local regulations for prevention of accidents will apply.

1.0. Safety



1.2. Safety advises

Please pay attention to the safety advises:

Danger indicates to an immediately imminent danger which may cause death or most serious injuries.

Warning indicates to a possibly dangerous situation which may cause death or serious injuries.

Caution indicates to a situation which may cause slight injuries, material damages or malfunctions.

Attention indicates to a situation or eventuality which should be considered.

Device-specific:

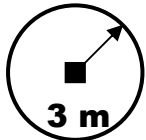

Please read the following safety instructions carefully:

- The mixer should only be operated and maintained by authorised and fully qualified and trained staff.
- The operator has to take care that with the mixer in switched-in condition no other person will stay in the vicinity of the machine. He is liable in front of third persons.
- Range of protection: 3 meters.
- Juveniles below 16 years are not allowed to operate mixer. Children have to be kept far from the connected machine.
- Please use your personal protective outfit during work.
 - Safety goggles
 - Ear protectors
- During work interruptions, switch off the mixer at the main switch.
- Danger of injury through dangling articles: (no jewellery like chains, rings, etc; use head dress for long hair!)
- Never overfill the mixing drum
- During work interruptions, switch off the mixer at the main switch
- Only the mixing materials should be in the drum. Remove all other items (rags, tools, etc.) before plugging in.
- Exchange or renew worn parts immediately.

1.0. Safety



Electric's:

Please carry out any electric work (connections, repair work) only if you are a specialised electrician who knows how to work with dangerous voltages (characteristics are on the identification plate).



The nominal voltage is printed on the type plate. Please operate the machine only with the voltage and frequency specified. Safety fuses have to be installed or replaced by fuses showing the same specification.



Never start to operate the machine with open case caps. Never expose the machine to spray water. Liquids may cause defects or electric damages or other damages to the machine.



Install the connecting cable in a way that nobody can stumble over it. Examine the cable regularly with a view to damages or ageing. If the condition of the connecting cable is no longer impeccable, the machine has to be switched off.



Maintenance, repair work:

Carry out any maintenance or repair work only if the machine has been separated from the line.

Please carry out only the maintenance work described in this user information and take care that any service or repair work will be carried out only by qualified staff.

Please note that according to the product liability law our company will not be liable for any damages caused by our machine in the event of inexpert repair work or if non-original spare parts were used for replacement of parts.

Spare parts and accessories can be ordered directly from our company.

1.0. Safety



Generally:

Never permit that the mixer is operated if anything is defect or if the safety cannot be guaranteed. Check the safety equipment regularly with a view to its good fixture and function. Never modify or remove the safety equipment or warning signs.

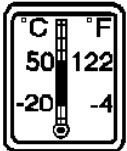

Never modify the machine without previous consent in writing by the manufacturer. Take care that the mixer will be operated only within the specified ambient temperature range of - 20 ... + 50 °C (-4 ... + 122 °F). An extremely high or low temperature can provoke malfunctions or damages.



Pay attention to operate the control as described in the user information. Do not close or block the aerating slots. The mixer must stand on a plane and solid ground. If it is operated in generally accessible areas and partly without supervision, safety precautions according to the special individual case have to be taken.



Take care that the machine will not be operated if it is submitted to strong magnetic fields, electric currents, radiation or strong vibrations as these could provoke malfunctions. Pay attention to have provided for a sufficient illumination (200 lx). High noise level: Use an ear protection.



The machine should be switched off under the following circumstances:

- if the feed lines are damaged;
- if the machine does not work correctly although it was operated in accordance with the present manual;
- if there are persons in the danger area.

Switch off the mixer by means of the main switch and draw out the mains plug before:

- cleaning activities;
- inspection of the connecting cables;
- going away;
- transport;
- if the machine will not be operated for a longer time.

The mixture must not come into contact with the membranes of the eyes, nose or mouth. If it does, wash directly with clean water, and take first aid steps.

Pay attention that the mixer is operated only by persons who have read and understood the user information and who have a minimum age of 16 years.

Maintenance, repair work, replacement of parts, transport only by authorised, qualified people.

2.0. Machine data

2.1. Technical Data

Designation: Diem mixer
 Type: D 100/120/150 cLe
 Machine no.: see page 3
 Year of construction: see page 3
 Certificate of conformity: see page 3 and annex

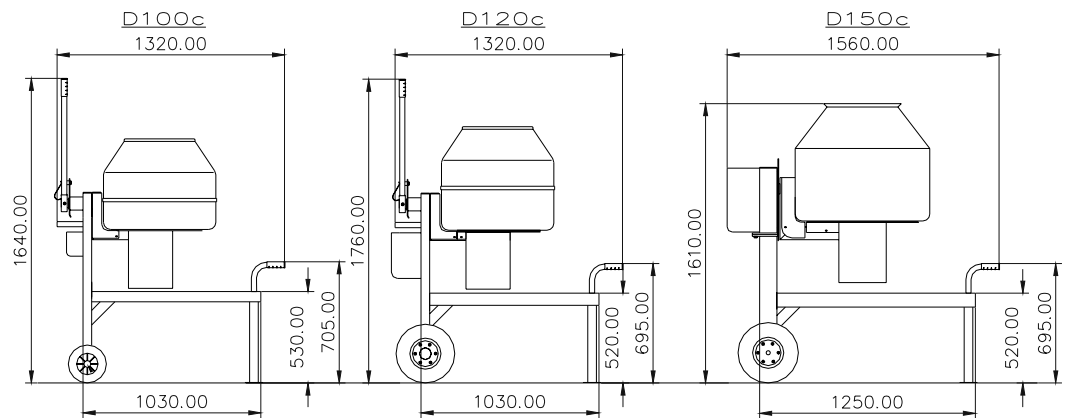

Technical data	D100c	D120c	D150c	Dimensions
Length	1320	1320	1560	mm
Width	870	920	970	mm
Height	1640	1760	1610	mm
Weight approx.	94	110	190	kg
Charging height	1140	1220	1240	mm
Discharging height	495	550	610	mm
A-sound level Idle running LpA	25	25	30	dB(A)
A-sound level operating LpA	55	55	60	dB(A)
Minimum illumination at work	200	200	200	Lx
Ambient temperature	-20...+50	-20...+50	-20...+50	°C
Lacquering	RAL1013	RAL1013	RAL1013	

2.0. Machine data

Tech. Data	D100c 230V	D100c 400V	D120c 230V	D120c 400V	D120c 230/400V	D150c 230V	D150c 400V	D150c 230/400V	unit
Drum									
Rpm	27	27	27	27	27	27	27	27	min-1
Drum capacity	150	150	170	170	170	270	270	270	l
Mixing capacity	100	100	120	120	120	150	150	150	l
Drum diameter	640	640	640	640	640	800	800	800	mm
Drum height	575	575	630	630	630	670	670	670	mm
electricity									
operating voltage	230	3x400	230	3x400	230 / 3x400	230	3x400	230 / 3x400	V~
frequency	50	50	50	50	50	50	50	50	Hz
power	0,55	0,55	0,75	0,55	1,1	1,5	1,1	2,2	kW
connection	Schuko Plug	CEE Plug	Schuko Plug	CEE Plug	Schuko / CEE	Schuko Plug	CEE Plug	Schuko / CEE	
Protection	16	3x16	16	3x16	16/3x16	16	3x16	16/3x16	A
Drive motor									
operating voltage	230	3x400	230	3x400	230 / 3x400	230	3x400	230 / 3x400	V~
frequency	50	50	50	50	50	50	50	50	Hz
power	0,55	0,55	0,75	0,55	1,1	0,75	0,55	1,1	kW
Protection	IP54	IP54	IP54	IP54	IP54	IP54	IP54	IP54	
Gearbox									
Type DIEM	SG27	SG27	SG27	SG27	SG27	SG27	SG27	SG27	
Type DIEM Tilting	-	-	-	-	-	SSG6	SSG6	SSG6	
Tilting Gear Box									
operating voltage	-	-	-	-	-	230	3x400	230 / 3x400	V~
frequency	-	-	-	-	-	50	50	50	Hz
power	-	-	-	-	-	0,75	0,55	1,1	kW
Protection	-	-	-	-	-	IP54	IP54	IP54	

2.0. Machine Data



2.2. Ordering of spare parts

Important!

The spare parts used have to comply with the requirements of the machine manufacturer. Please use only original spare parts from the company Diem-Werke.

Indications needed with your order:

Type:	D 100c; D 120c; D 150c
Year of construction	see page 3
Machine number:	see page 3
Operating voltage:	400 V; 230V
Required piece number:	pieces
Article number, designation:	from separate spare part list



2.3. Guarantee

A **guarantee of 12 months** is granted by us on the DIEM mixer.

1. This guarantee applies exclusively to faulty material or manufacturing faults. No guarantee claims will be accepted for damages caused by inexpert use or non-observance of the user information. A further responsibility will not be taken over.
2. Any objection concerning the machine has to be noticed to us within 8 days after receipt of the goods and, in the event of hidden faults, immediately after their discovery.
3. Guarantee claims can only be raised for machines which have not been in any way modified, adjusted or repaired by the customer or third parties. Our guarantee will apply only to original parts.

3.0. Device description



3.1. Description

- Tilting Drum mixer with 100 lt. (D100 c), 120 lt. (D 120c) or 150 lt. (D 150c) usable mixing capacity
- Portable, with hand transport handle.
- Solid rubber wheels
- Solid steel sub frame
- Drive unit over a directly flanged maintenance-free spur gearing with DC or AC motor.
- Side fed with either liquid or mixing products through opening on the drum neck.
- Emptied by tipping the drum. (D100c and D120c manually operated, D150c with tipping gear.)

Safety Features

Shear areas protected by safety devices

Simple Hand Operation

- High stability from three points of contact stance.
- One switch operation.
- Tipping gear for 150 litre machine.



4.0. Transport

4.1. Dimensions:

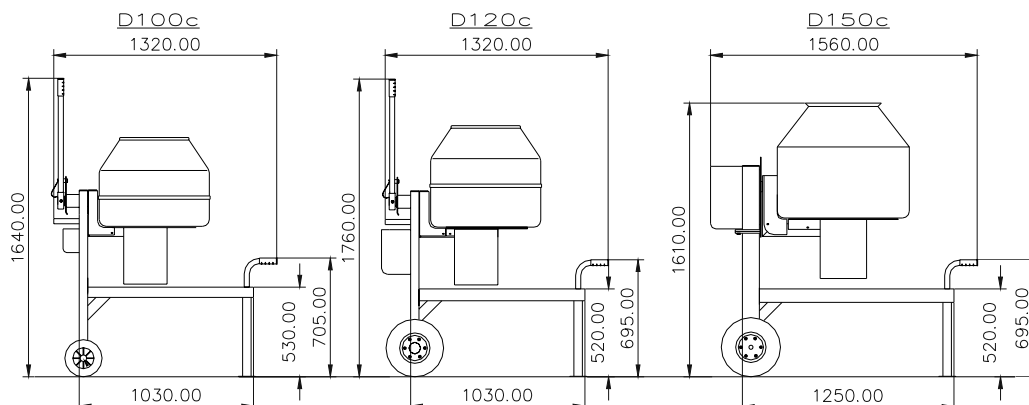

	D100c	D120c	D150c
Weight	94 kg	110 kg	190 kg
Load on Towbar	27 kg	27 kg	38 kg



4.2. Transport:

Warning: Heavy load, transport only by authorised, qualified staff.

Use protective shoes as your personal protective outfit during the work.

Make a check whether all parts are contained in the shipment. Transport damages have to be notified immediately to the forwarding agent.



4.3. Storage:

- never store the mixer with tilted drum (water penetration)
- use stockyard with roofing

5.0. Mounting / Starting

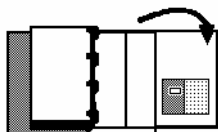

Open the folder at the end of the user information to have an illustration of the machine parts available at any time.



Warning:

Pay attention to have the connecting line installed in a way that it will not cause any risk. (Stumbling etc..).

Pay attention to have provided for a sufficient illumination (200 lx)
Set the mixer on a solid and plane ground.

Only allow installation at the hands of a qualified expert.

5.1. Site, Feeding

Connecting values:

The connection of the mixer is made through 16A plugs. The socket requires the following feeder line:

mixer	D100c	D100c		units
operating voltage	230	3x400		V
frequency	50	50		Hz
power	1,3	1,1		kW
protection	16	3x16		A
plug	Schuko	CEE		
connection	L, N, PE	L1, L2, L3, N, PE		
mixer	D120c	D120c	D120c	
operating voltage	230	3x400	230/3x400	V
frequency	50	50	50	Hz
power	3	2,8	2,8	kW
protection	16	3x16	3x16	A
plug	Schuko	CEE	Schuko / CEE	
connection	L, N, PE	L1, L2, L3, N, PE	L1, L2, L3, N, PE	
mixer	D150c	D150c	D150c	
electricity	230	3x400	230/3x400	V
frequency	50	50	50	Hz
power	3	2,8	2,8	kW
Protection	16	3x16	3x16	A
Plug	Schuko	CEE	Schuko / CEE	
Connection	L, N, PE	L1, L2, L3, N, PE	L1, L2, L3, N, PE	

5.0. Mounting / Starting



5.2 Set up

Warning

Defective connecting cables are dangerous to life. Never use defective cables. Inspect the connecting cables in regular intervals with a view to defective points!

Before carrying out your inspection, convince yourself that the line has been switched off that means separated from the mains (unplugged). Make an inspection of the cable inlets at the plugs and coupling bushes with a view to bent points.



5.3 Feeding

Attention

Operate the mixer only by means of a TÜV-tested line. Pay attention to have a sufficient cross section of a minimum of 2,5 mm².

Electricity cables must be of a type intended for use in the open. e.g.

Rubber tubing cables HO7RN-F
(DIN 57282 Part 1 / VDE 0282 Part 1)
Flexible cables with Polyurethane coating
(DIN 57250 / VDE 0350 Part 818)



Caution

Connecting lines can be hampering, and persons can stumble over them. Pay attention to have the lines led away behind the machine. If using an extension cable, unwind the roller completely to avoid any development of heat.

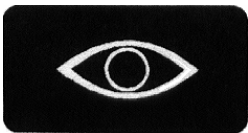

Use extension cables with a sufficient cross section to keep the line drop as low as possible.

An extension cable must not be of a lesser type than the cable as described for the mixer. The coupling plug of any extension cable must be water resistant.

When employing an extension cable, completely unroll the cable to avoid a build up of heat.

5.0. Mounting / Starting



5.4. Connection

Connection to the electric network

Before carrying out the connection, make a check of the following points:

- Mixer on solid an plane ground
- Connecting cable in good order.
- Compliance between the data on the type plate of mixer and your electric network.

When connecting your mixer, take care that the protective measures of the electric power supply company will be observed.

Attention

Transportable equipment which is to be used out of doors, must be connected to a current leakage fuse box.



5.5. Safety equipment

Attention

The mixer must be connected through a fault current protective switch.

Warning

Operate the mixer only with mounted safety equipment. Check the safety equipment in regular intervals with a view to its fixture and good function. Never evade, remove or make the safety equipment unfit. Never remove the warning signs.



5.6. TEST RUN

- Plug the mixer into a 16A earthen socket (230V-Model) or a 16 A CEE-type socket (380V-Model)
- Turn the Master Switch to position 1

If the procedures described have been followed, the CEE-type socket should produce a clockwise rotation.

CAUTION

Incorrect direction of revolution diminishes the mixer performance!

If the drum turns against the arrow direction (arrows on mixing drum), , the phases must be changed at the CEE-type socket. This applies only to Power Model machines (400V model)

5.0. Mounting / Starting

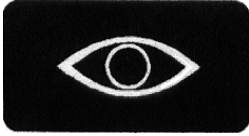

5.7. Dismantling the mixer

- Set the Master Switch to position 0
- Unplug the main supply (pull at the plug not on the cable)
- Roll up the cable
- Clean the machine

6.0. Setting up and Turning on

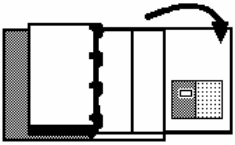

Open the plate at the end of the User - Information in order to have an overview of the machine parts in front of you.

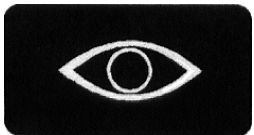

6.1. TRANSPORT TO THE SITE

- unload the mixer from the lorry with a suitable lifting device
- use transport handle to transport the mixer to the site
- place the mixer securely on plane and solid ground (capable of supporting a load). Ensure sufficient illumination (200lx)

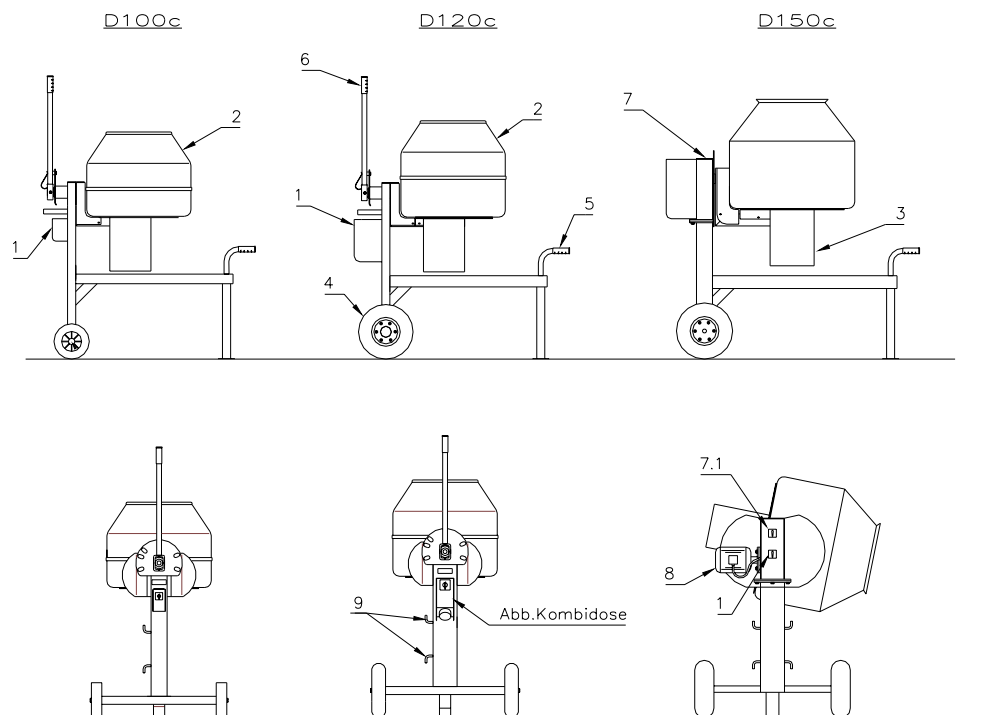

6.0. Setting up and Turning on

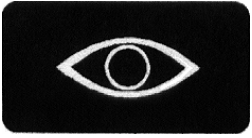

6.2. Setting up and Turning on

- Bring the mixer into position.
- In order to increase the stability of the mixer, the machine should be placed with two bricks or wooden blocks underneath the axles. This relieves the wheels of their load (ensuring a longer life) and, though its more rigid stance, protects the mixer from swaying or rocking.

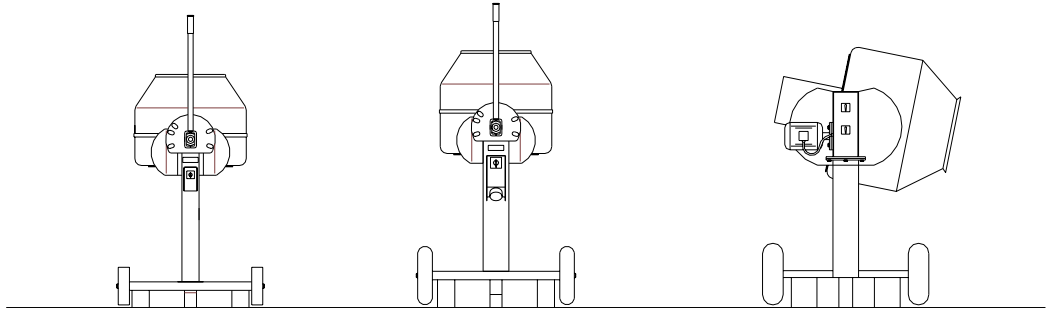

Warning

Installation, cleaning, maintenance and repair only by authorised, qualified staff.

6.3. Connection (feeder)

electricity	D100c 220V	D100c 400V	D120c 220V	D120c 400V	D120c 230/400	D150c 230/400 V	uni
operating voltage	230	3x400	230	3x400	230 / 3x400	230 / 3x400	V~
voltage	±5	±5	±5	±5	±5	±5	%
protection	16	3x16	16	3x16	16 / 3x16	16 / 3x16	A
frequency	50	50	50	50	50	50	Hz
power	0,55	0,55	0,75	0,55	1,1	2,2	kW
plug	Schuko	CEE	Schuko	CEE	CEE / Schuko	CEE / Schuko	
connection	L, N, PE	L1,L2,L3, N, PE	L, N, PE	L1,L2, L3,N, PE	L, N, PE / L1,L2, L3,N, PE	L, N, PE / L1,L2,L3, N, PE	

7.0. Operation

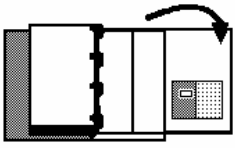

**Read the User - Information carefully before installation.
Open the plate at the end of the User Information to have an
overview of the machine parts in front of you.**



Check the following before mixing:

- Mixer is standing on strong, level ground.
- Correct revolution direction.
- Cables and extension cables are in sound condition (see p.14) and lead away from behind the machine.
- Safety devices are attached. Personal safety guidelines are being adhered to.



Safety Goggles



Ear Protectors

WARNING

Escaping mix products can lead to injuries
Wear your safety clothing



7.0. Operation



7.2. Operational safety

WARNING

Only operate the mixer with all the safety features enabled. Never bypass, remove or render the safety features unusable



CAUTION

- Mistakes occur through insufficient illumination
- Beware of protruding parts (Tow bar)
- Do not work in the dark! Minimum illumination: 200 lux



WARNING

- Escaping mix products can lead to injuries
- Wear Safety Clothing



IMPORTANT

- Supply cable and extension leads must be checked for damage before use. When damaged, unplug the machine from the mains, and secure it against being plugged back in
- Never operate the machine when any part is known to be defective



IMPORTANT

- Clean the mixer after every use
- Exclusion Zone 3 meters
- Must be operated by properly instructed personal only Minimum age: 16
- The operator is responsible for ensuring that no children or unprotected personnel come within the vicinity of the machine

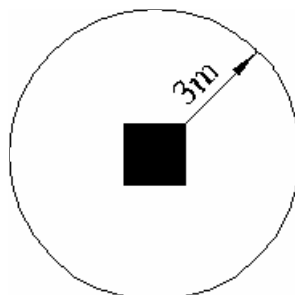

7.0. Operation

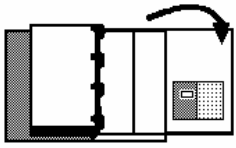

7.3. Turning on

Open the plate at the end of the User Instructions to have an overview of the machine parts in front of you.

Before turning on, check that all safety features are operational



WARNING

Rotating drum is dangerous!

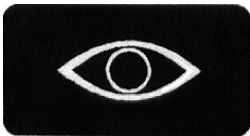

- Plug into a 16 A socket
- Set the master switch to position **1**, to allow the motor to warm up
- Check that the drum is rotating in the direction of the arrows (arrows on drum ... applies only to 380V mixers)
- If the direction of rotation is wrong, unplug the CEE - type socket and, with the help of a screwdriver, turn the phase changer



CAUTION

Incorrect revolution direction leads to poor mixing results.

If the prescribed procedures have been followed, the CEE socket will produce a clockwise rotation. The mixer is set to work in position **1**



7.4. Tip for operation

The following steps will aid you in dealing with your mixer and the mixing products :

Before mixing, inspect the mix for foreign objects (e.g. hammer, tools, ...)

7.0. Operation

7.5. Mixing

IMPORTANT

The mixer may only be used by people who are familiar with the operating instructions. They must have suitable experience and to have been instructed in the accident prevention guidelines

Exclusion Zone : 3 meters

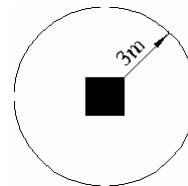

Operation only by instructed personnel. Minimum age, 16 years old. The operator is responsible for insuring that no children or unprotected people enter the vicinity of the machine.

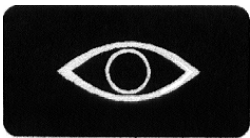

- With the mixer running, fill it from the side directly into the rotating drum
 - Use the tipping arm (16) or the tipping switch to empty the running mixer
- IMMEDIATELY** upon completion of the mixing process:
- Set the Master Switch to **0**
 - Remove the plug from the mains socket, and roll up the cable.
 - Thoroughly clean the mixer (if the mixer is going to be left for a period of time, the mixer must be oiled)



DANGER

In the case of malfunction: Immediately turn the mixer off, and unplug it. Get it looked at by an expert



7.6. Turning off the mixer

Important

In the case of malfunction: **PULL THE PLUG !!**



- Turn the Master Switch to 0.
- Pull the plug from the socket (do not pull on the cable)
- Roll the cable up
- Clean the Mixer. (oil the machine if it is to be left standing for any length of time)

8.0. Components and conversion



IMPORTANT

Only use **ORIGINAL** accessories! Safety cannot be guaranteed when any accessories other than those guaranteed by us have been used.

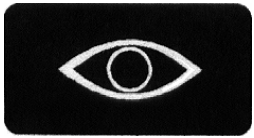

8.1. COMPONENTS

Only the following specified accessories may be used in conjunction with the tilting drum mixers **D100c**, **D120c** and **D150c**. Unchecked accessories can lead to danger.

Dust Protection Cover

Dust can lead to lung diseases. A special lid for protection against escaping dust can be obtained for the mixing of dry or powdered materials.

Mixing of Foodstuffs.

A special steel chromed drum is available for this purpose. (V4a 1.4435 or 1.4436 or 1.4571)

Modifications

Only by



or authorised service agency.

9.0. Problem resolution

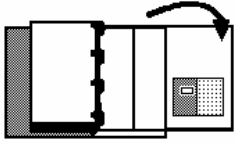

No manual is able to contain the resolution of all the problems which may appear. This section is intended to show you a method which will lead you to the faulty point and give you an advice for its repair.

9.1. BEFORE BEGINNING

If the mixer does not function properly, first check for visible signs of damage. Ensure that the mixer is turned on, that the Master Switch is on position **1**, and that the safety features are intact.



WARNING

**Upon opening the Mixer, dangerous, high voltage parts are exposed (switching box, terminal board)
Contact with electrically active can leads to serious injuries or death.**



DANGER

Imperfect repair work leads to serious injury. Only allow repairs to be carried out by a specialist service agency.



9.2. Fault finding

IMPORTANT

Immediately cease work by malfunction. Separate the machine from the mains and have the fault checked by a qualified specialist.

Problem	Possible source	Correction
Motor does not run	No mains voltage	Check protection, switch main switch to 0 .
	Feeder or plug damaged	Change feeder, have contact with a specialist
Motor overheating, less power, motor stop	2 phase instead of 3 phase	Stop the mixer immediate, specialist has to check the feeder
	Overload Motor protection released	Let the motor cool down, turn main switch to 0 than again to 1
D150c drum is stuck	Incorrect revolution direction	unplug the CEE - type socket and, with the help of a screwdriver, turn the phase changer

10.0. Maintenance

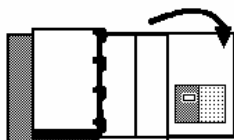

Careful use and responsible maintenance is essential for optimum efficiency of your mixer. Clean the mixer after every use, carry out the maintenance work conscientiously, and replace the mixing gear (when worn) in good time.

Open the plate at the end of the User - Information in order to have an overview of the machine parts in front of you at all times.

IMPORTANT

Cleaning, maintenance and repair work should only be carried out on an unplugged machine and by a qualified specialist. All safety regulations must be observed.

MAINTENANCE

Before maintenance and repair work is carried out, set the Master Switch (1) to position 0, separate the machine from the mains supply and roll up the cable



10.1. CLEANING

CAUTION

Strong cleaning materials can dissolve the paint finish and the warning signs. Never use nitrous or other aggressive or combustible agents when cleaning the machine

IMPORTANT

Never clean the switching box with a high pressure cleaner. The mixer is resistant to water sprays. Thoroughly clean the machine after use with a brush and hose.

CAUTION

Impurities in greased or oiled parts can lead to their damage. Never blow air directly into the guideshoes, bearings or screw threads.

Oil exposed parts if the machine has been lying idle for more than two weeks.



10.2. FINISHING

For the touching up of scratches, use only the following standard finish: RAL 1013, White

10.0. Maintenance

10.3. Replace Fuses

Only replace fuses for ones with identical specifications

Item	Type	Value
Mixer	NH - Fuse or Automatic	16 A load



10.4. Maintenance

TIP

By prudently timing the replacement of worn out or used parts, unnecessary machine inactivity and poor mixing results can be avoided



Pos.	Part	Maintenance Work	daily	monthly
1	Mixer	Cleaning	X	
2	Mixer	Check the safety features	X	



10.5. REPAIR

You can assist in lessening the time required for finding and fixing faults if you can accurately describe the problem before contacting the relevant expert, or taking the machine to be repaired.

IMPORTANT

Only carry out repair work on an unplugged machine, and if you are a qualified expert.



MAINTENANCE

Upon opening the machine, dangerous high voltage points (switching box, terminal board on the motor, etc.) are exposed. Before commencing work, set the Mator Switch to position 0, separate the machine from the mains electricity and roll up the cable.



10.0. Maintenance

10.6. Grease change

The geared motor is maintenance - free, a grease change is only necessary when the motor or the gearbox is repaired.

SHELL Gearbox Grease H 0.5 Litres

Dispose of waste grease thoughtfully!



10.7. Disposal

Worn-out mixers have to be withdrawn immediately from service and marked accordingly and thereafter carried to an adequate disposal. Remnants have to be separated and disposed off.



10.8. After-sales service

In case of needing assistance:

Please copy this page and fill it up accordingly. The more information we will get, the earlier we will be able to make a correct diagnosis and supply a quick service.

Send this copy by telefax to DIEM-WERKE +43 / 5574 / 46418 or your nearest After Sales Service organisation.

Device:: **DIEM MIXER D 100/120/150c**

Year of construction:

Machine no.:

Date of purchase:

Description of your problem:

Sender:

Company::

Corresponding partner:

Division:

Address:

Phone:

Telefax:

Stamp:

10.0. Maintenance



10.9. Service

We have, at the time of printing, representatives in the following countries You can contact us on the telephone number +43 / 5574 / 42874, to obtain the address of your nearest service agency.

DIEM - Werke Ges.m.b.H. & Co
Postfach 2
Lindauer Straße 60
A - 6911 Lochau
Tel: +43 / 5574 / 42874
Fax: +43 / 5574 / 46418

EUROPA

Belgium

Germany

Finland

France

Great Britan

Irland

Norway

Austria

Sweden

Switzerland

Spain

Hungary

Other Countries

Australia

Israel

The Far East

The USA



Designation of the machine parts

Open the folder to have at any time an illustration of the machine parts available.

The following documents are annexed to this user information:

1. **Reply card:** Please return our reply card with your comments. This will help us to improve the quality of our user information.
2. **Designation of spare parts**
3. **Certificate of Conformity**



11.1 . Wear parts

Art. Nr.	D100c / D120c / D150c
1262	spring for tilting lever
1186	Plastic handle
12401	Drum complete for D100c
12400	drum complete for D120c
12398	drum complete for D150c



CE – Certificate of Conformity

This machine does conform with all relevant safety and sanitary requirements and is entitled to bear the CE distinguishing mark.